

# FUSION™ D400Q

4-Bay Serial ATA Disk Enclosure with Quad Interface

## User's Guide



USB 1.1 & Hi-SPEED  
**USB 2.0**  
READY



For  
Windows

Creativity Stored Here™

**SONNET™**  
SIMPLY FAST™  
[www.sonnettech.com](http://www.sonnettech.com)

# Fusion D400Q Specifications and Features

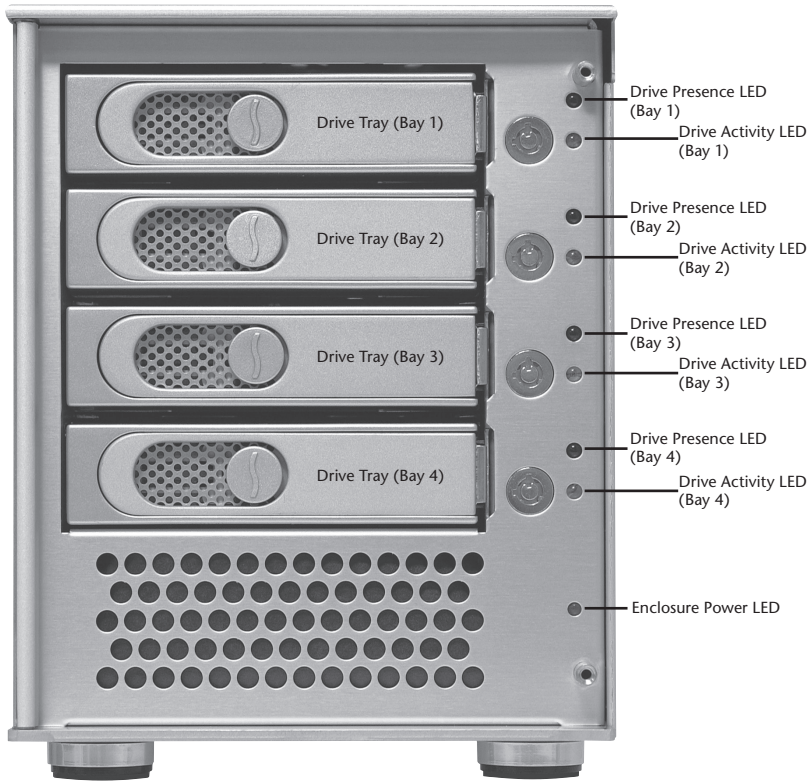

Figure 1

## Enclosure Specifications

Compatibility	Compatible with Mac®, Windows®, and Linux® computers with compatible interface
Interface Connectors	eSATA, 2x FireWire® 800, FireWire 400, Mini-USB
Drives Supported	3 & 1.5 Gb/s Serial ATA; 7,200 RPM
Data Transfer Speed	Up to 220MB per second, depending on interface used and configuration
OS Support	Platform independent
Power Supply	100–240V, 50–60Hz
Operating Temperature	32 to 95° F (0° C to +35° C)
Dimensions (WxDxH)	5.9 x 11.25 x 7.5 in (14,9 x 28,5 x 19 cm)
Weight	10.8 lbs (4.9 kg)
Package Contents	Disk enclosure, four 3.5" drive trays, drive tray keys, drive mounting screws, tube of threadlocker, power cord, 2-meter locking eSATA data cable, 6-inch eSATA data cable, 2-meter FireWire 800 cable, 1-meter FireWire 400 cable, 1-meter USB cable, User's Guide

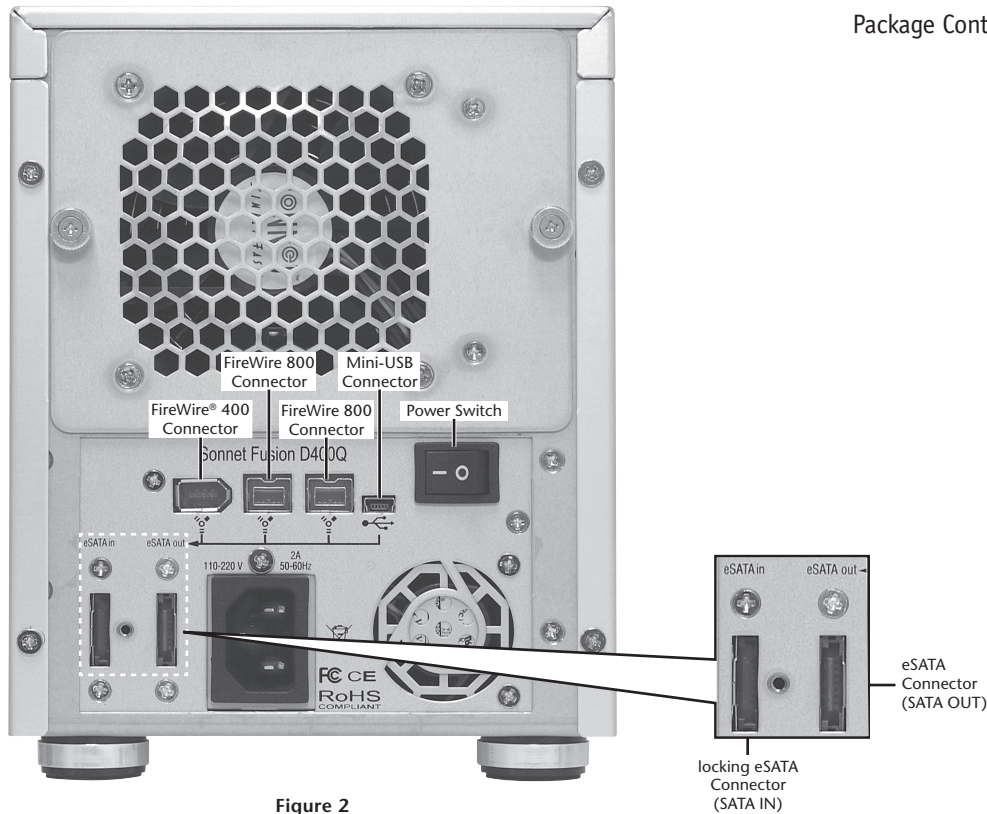

Figure 2



**Support Note:** Your Fusion D400Q's port layout may appear different than what is pictured in this guide.

## Safety Precautions and Disclaimers

### SAFETY PRECAUTIONS

Please read this section carefully before proceeding. These precautions explain the correct and safe use of this device, thereby helping to prevent injury to you or others, and also help you to minimize the risk of damaging the device.

#### Warnings

Always follow the basic warnings listed here to avoid the risk of serious injury or death from electrical shock, short-circuiting, fire, and other hazards. These warnings include, but are not limited to:

- With the exception of the user-swappable parts, do not attempt to disassemble or modify the enclosure. If this device appears to be malfunctioning, contact your reseller or local distributor.
- Do not drop the enclosure or any of its drive modules; dropping or mishandling of the enclosure or drive modules may result in a malfunction.
- Do not insert your fingers or foreign objects inside the enclosure; take particular care when small children are present.
- Do not expose the device to rain, use it near water or containers that contain liquids which might spill into any openings, or in damp or wet conditions.
- If unusual smells, sounds, or smoke come from the device, or if liquids enter it, switch it off immediately and unplug it from the electrical outlet.
- Follow the instructions in this manual carefully; contact your reseller or local distributor for additional advice not covered in this User's Guide.

### DISCLAIMERS

#### Creating RAID Volumes Using Windows:

Creating RAID volumes under Windows requires dynamic disk storage, a formatting option available with Windows Server 2008 R2, Windows Server 2003 SP1, Windows 7 Professional, Enterprise, or Ultimate (32- and 64-bit versions), Windows Vista Enterprise or Ultimate (32- and 64-bit versions), or Windows XP Professional (32- and 64-bit versions).

In order to create RAID volumes larger than 2TB, you must do one of the following:

- Span (link together in a virtual chain) the volumes, and then format them as NTFS.
- Use GPT formatting. Note that drives and volumes with GPT formatting are not visible to any version of Windows XP Professional, nor to the 32-bit version of Windows Server 2003 SP1.

### DISCLAIMERS

#### Drive Usage:

Sonnet Technologies has qualified the hard drives listed below for use in Fusion D400Q storage systems. These drives were chosen for their superior performance, error handling, and reliability characteristics, especially when used in RAID groups. One important difference between these drives and standard hard drives is how quickly each handles read errors—these qualified drives attempt to recover from errors for just a few seconds, while standard hard drives may take minutes. Because RAID controller cards and software-based RAID schemes allow only a very short time for drives to recover before dropping them from the RAID group, hard drive manufacturers recommend against using standard hard drives in RAID storage systems. The hard drives qualified by Sonnet also feature improved vibration characteristics that influence and support storage reliability. We recommend the use of these Enterprise/RAID edition hard drives and select, Sonnet certified desktop hard drives in your Fusion storage system to ensure system reliability and performance. STANDARD DRIVES MAY NOT BE SUPPORTED AND MAY DEGRADE SYSTEM RELIABILITY AND PERFORMANCE. **Check the Sonnet Web site for the latest list of qualified hard drives.**

#### 500GB Models

- Hitachi Deskstar E7K500, # HDS725050KLA360
- Hitachi Ultrastar A7K1000, # HUA721050KLA330
- Maxtor MaXLine Pro 500, # 7H500FO
- Samsung Spinpoint F RAID, # HE502IJ
- Seagate Barracuda ES, # ST3500630NS
- Seagate Barracuda ES.2, # ST3500320NS<sup>(1)</sup>
- Western Digital RE3 Enterprise, # WD5002ABYS

#### 750GB Models

- Hitachi Ultrastar A7K1000, # HUA721075KLA330
- Samsung Spinpoint F RAID, # HE753LJ
- Seagate Barracuda ES, # ST3750640NS
- Seagate Barracuda ES.2, # ST3750330NS<sup>(1)</sup>
- Western Digital, RE3 Enterprise, # WD7502ABYS

#### 1TB Models

- Hitachi Ultrastar A7K1000, # HUA721010KLA330
- Samsung Spinpoint F RAID, # HE103UJ
- Seagate Barracuda ES.2, # ST31000340NS<sup>(1)</sup>
- Western Digital, RE3 Enterprise, # WD1002FBYS

#### 1.5TB Models

- Seagate Barracuda 7200.11, # ST31500341AS<sup>(2)</sup>

#### 2TB Models

- Hitachi Ultrastar DK7SAA200, # HUA722020ALA330
- Western Digital RE4-GP, # WD2002FYPS

(1) Only Seagate ES.2 drives with firmware versions SN06 and newer compatible. Seagate ES.2 drives with firmware versions SN03, SN04, or SN05 are NOT compatible.

(2) Only Seagate Barracuda 7200.11 1.5TB drives with firmware versions SD1B and newer compatible.

## Drive Installation and Enclosure Setup

### Attach Drive Trays to Drives

1. Remove the Fusion D400Q and its drive trays from their packaging, and place them near the computer to which the enclosure will be connected.
2. Take one of the drive trays and push its lever release button in until the lever pops out (Figure 3).



**WARNING:** When handling computer products, take care to prevent components from being damaged by static electricity; avoid working in carpeted areas. Handle hard drives only by their edges and avoid touching connector traces and component pins.

3. Remove a SATA drive from its packaging and set it in on a flat, level surface with the label side down. Open the supplied tube of threadlocker and apply a *single* drop inside each of the four indicated screw holes on the bottom of the drive (Figure 4).

4. Turn the drive tray upside down and lay it on top of the drive, with the back of the tray facing toward the drive's connectors (Figure 5).



**WARNING:** When securing the trays to the hard drives, you must verify the screw heads are flush with the tray. Otherwise, a screw may catch on the tray below and prevent you from removing the tray from the enclosure.

5. Using four of the supplied screws, secure the drive tray to the drive; tighten each screw to secure the tray snugly to the drive; **do not overtighten the screws** (Figure 6).

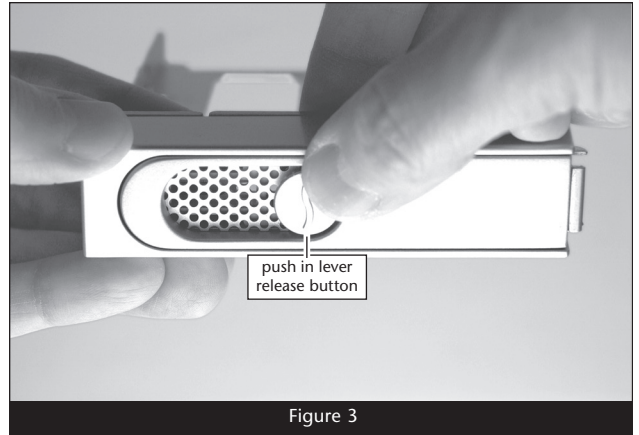

Figure 3

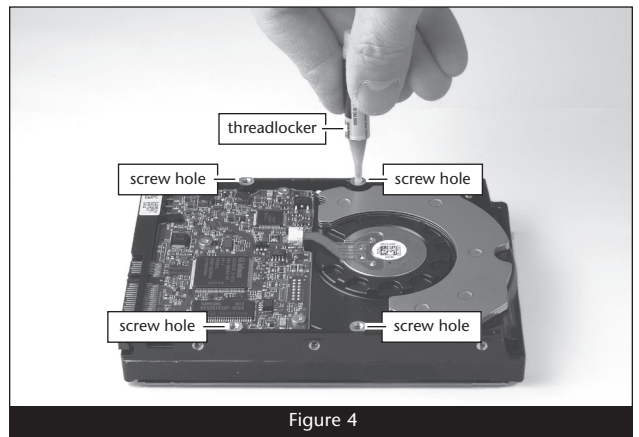

Figure 4

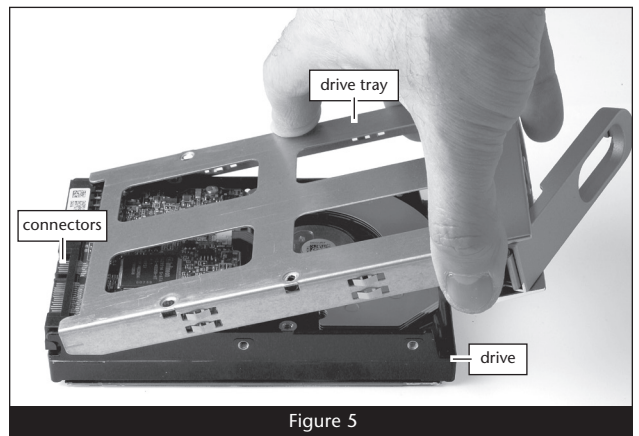

Figure 5

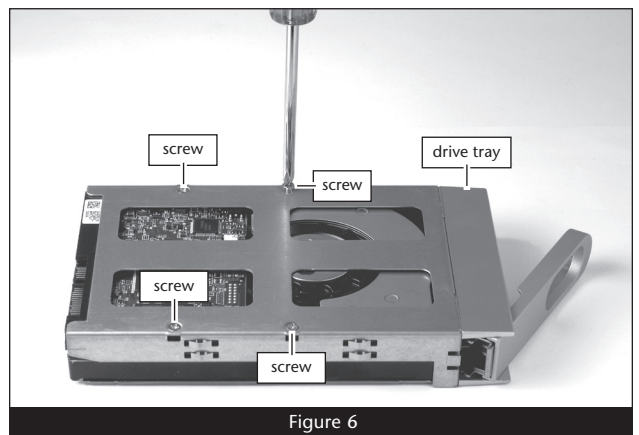

Figure 6

## Drive Installation and Enclosure Setup



**WARNING:** When inserting drive modules into the enclosure, **do not force the levers closed**. If a lever does not close easily, remove and reinsert the module, and then push the lever in again.

6. Carefully slide the drive module into the enclosure until its lever starts to close, and then push the lever in until it clicks to secure the drive module inside the enclosure (Figure 7).
7. Repeat steps 2-6 for additional drives.

### Connect Fusion D400Q to SATA Host Controller Card

This section describes the connection of the Fusion D400Q to your computer's SATA host controller card. **Note:** *Your Fusion D400Q's port layout may be different than what is pictured in this guide.*

1. Connect the supplied locking eSATA data cable between the **SATA in** port on the enclosure and the SATA host controller in your computer; **verify the connectors are plugged in securely** (Figure 8). Skip to "Finish Setup" below.



**Support Note:** The supplied Sonnet locking eSATA cable is compatible with all eSATA ports and provides a far more secure connection when used with Sonnet drive enclosures and host controller cards with the matching connector. If necessary, you may remove the locking mechanism from the connector by removing the screws securing the two halves.

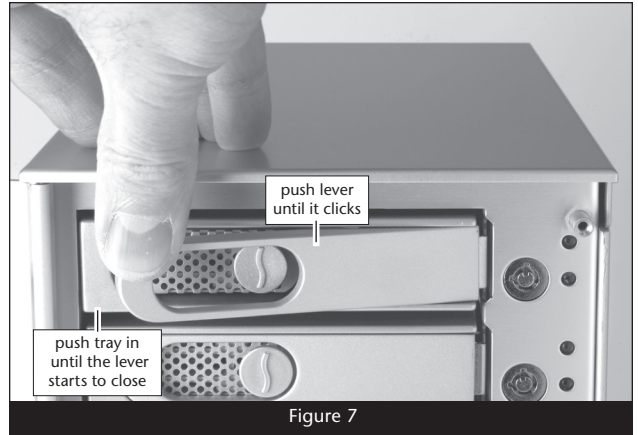

Figure 7

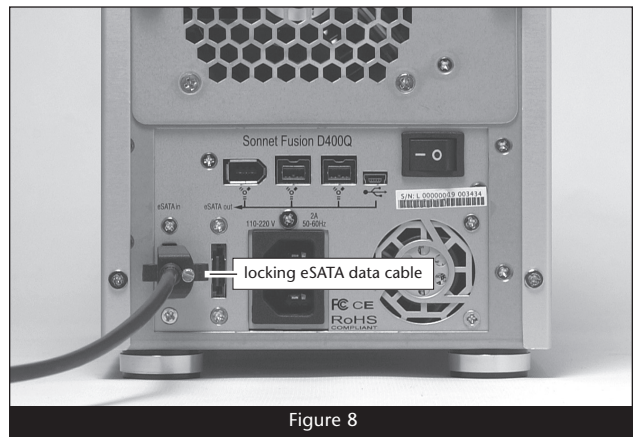

Figure 8

### Connect Fusion D400Q to a FireWire or USB Port

This section describes the connection of the Fusion D400Q to your computer's FireWire or USB ports. If you intend connect the D400Q to your computer's SATA host adapter card, go back to the section above. **Note:** *Your Fusion D400Q's port layout may be different than what is pictured in this guide*

1. Connect the supplied 6" eSATA cable between the **SATA out** and **SATA in** connectors on the back of the enclosure (Figure 9).
2. Connect any *one* of the supplied USB or FireWire cables between the appropriate ports on the enclosure and host computer; **verify the connectors are plugged in securely** (Figure 10).

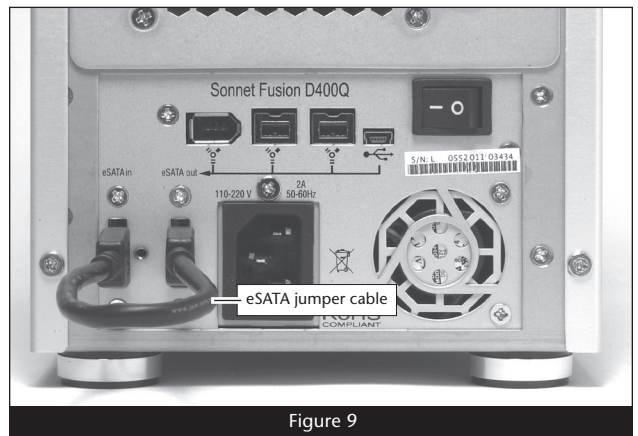

Figure 9

### Finish Setup

1. Connect the supplied power cable between the Fusion D400Q and a grounded wall outlet or power strip; **verify the cable is plugged in securely**.
2. Push the switch on the back of the enclosure to the on position, and then power on your computer.
3. Format the drives installed in the Fusion D400Q according to your needs; refer to your operating system software's guide or help section for more information.

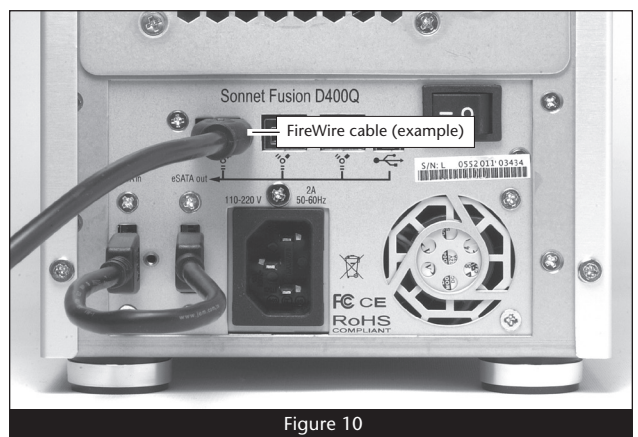

Figure 10

## Tips and Additional Information

This section covers some tips for using the Fusion D400Q enclosure.

### Hot-swapping drives:

**When connected via eSATA data cable to a Mac running Mac OS X, Fusion D400Q supports drive hot-swapping\***, enabling you to exchange a drive or a set of drives without having to shut down your computer. This does not mean you can simply pull out a drive at any time; you must follow the procedures below or you may lose data in the process.

- Before removing a drive module, you must put away (“eject”, “unmount”, “dismount”) the drive volume. Simply drag the drive icon associated with the drive(s) you wish to remove to the eject icon on the dock (or trash can on the desktop).
- If you remove a drive module from the Fusion D400Q that was part of a RAID set, you should power off the enclosure before reinserting the drive module. Once the module is secured, power on the enclosure again; this will ensure that the RAID set will mount properly.

\* Windows does not provide hot swap support for drives (drive enclosures) connected to a SATA host controller card installed in a desktop PC or server.

### Connections:

If you experience issues where a drive or volume does not appear on your computer, or you see an error message stating a drive is missing when you have the drives configured as a RAID set, the cause may be as simple as a loose connector.

- Disconnect the data cable and reconnect it, making sure end “clicks” in place.
- Check the drive presence indicator LEDs on the front of the enclosure. If the LEDs are not lit on one of the bays, remove and reinsert the drive module.
- **Whenever the Fusion D400Q is connected to your computer via FireWire or USB, the supplied 6" eSATA cable must be connected from the SATA out port to the SATA in port on the back of the enclosure.** If you do not have the cable connected between the two eSATA ports, no data will pass between the FireWire or USB connections and hard drives.

### Using the D400Q When Connected via FireWire or USB:

- **Fusion D400Q supports only one interface at a time.** Do not connect more than one cable at a time between the enclosure and computer; no damage will occur, but only one interface will function.
- When you connect the Fusion D400Q to your computer with a FireWire 400, FireWire 800, or USB cable, you must have a drive installed in bay 1 (top slot), otherwise drives in bays 2–4 will not be seen by the computer. This issue does not affect the D400Q when it is connected via eSATA.

## Contacting Sonnet Customer Service

### USA Customers

The Sonnet Web site located at [www.sonnettech.com](http://www.sonnettech.com) has the most current support information and technical updates. Before you call Sonnet Customer Service, please check our Web site for the latest updates and online support files, and check this User's Guide for helpful information. When you call Sonnet Customer Service, have the following information available so our customer service staff can better assist you:

- Product name
- Date and place of purchase
- Hard drive model(s)
- Computer model
- Operating system
- Software/firmware versions

If further assistance is needed, please contact us at:

### Sonnet Customer Service:

**Online Service Form:** <http://serviceform.sonnettech.com>

**Tel:** 1-949-472-2772

(Monday–Friday, 7 a.m.–4 p.m. Pacific Time)

**Fax:** 1-949-457-6349

**E-mail:** [support@sonnettech.com](mailto:support@sonnettech.com)

### For Customers Outside the USA

For support on this product outside the USA, contact your reseller or local distributor.

### Visit Our Web Site

For the most current product information and online support files, visit the Sonnet Web site at [www.sonnettech.com/support/](http://www.sonnettech.com/support/). Remember to register your product online at <http://registration.sonnettech.com> to be informed of future upgrades and product releases.