

Installation Instructions for MacCuff mini (2024+)

Required Tools – Monitor Mounting

- #2 Phillips (+) Screwdriver

Required Tools – Under-Desk Mounting

- Safety Glasses
- Painter's or Masking Tape
- Center Hole Punch (optional)
- Electric Drill
- Drill Bit (See Instructions for Size Details)
- #2 Phillips (+) Screwdriver

Required Tools – Wall Mounting

- Painter's or Masking Tape
- Level (optional)
- Hammer
- Center Hole Punch (optional)
- Electric Drill
- Drill Bit (See Instructions for Size Details)
- #2 Phillips (+) Screwdriver



Support Note: This document was up to date at the time of printing.

However, changes to the hardware may have occurred since then. Please check the Sonnet website for the latest documentation.

1. Go to <https://www.sonnettech.com/support/kb/kb.php>
2. Navigate to and click the MacCuff mini (2024+) link.
3. Click the Manual link.
4. Click the MacCuff mini (2024+) Installation Instructions [English] link and then check the Document Version information. If the version listed is later than this document (revision A), click the Download Now button for the latest version.

Monitor Mounting Instructions

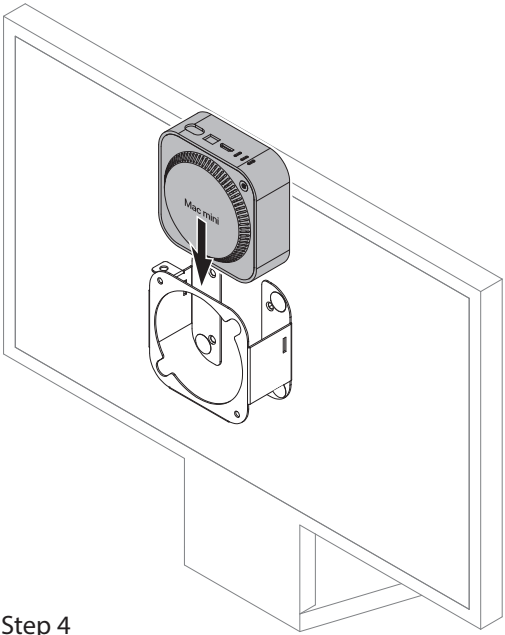
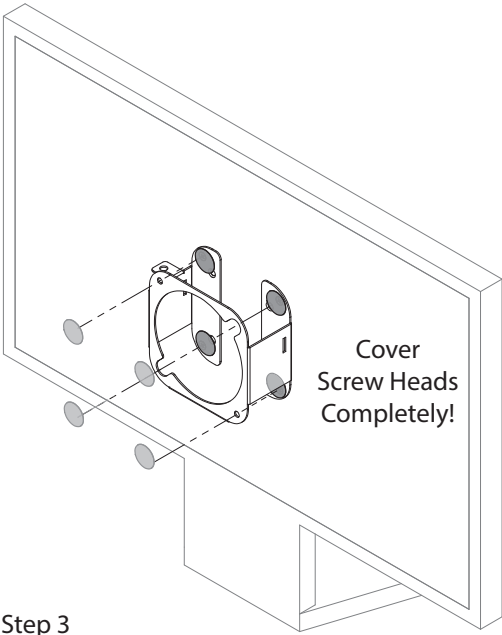
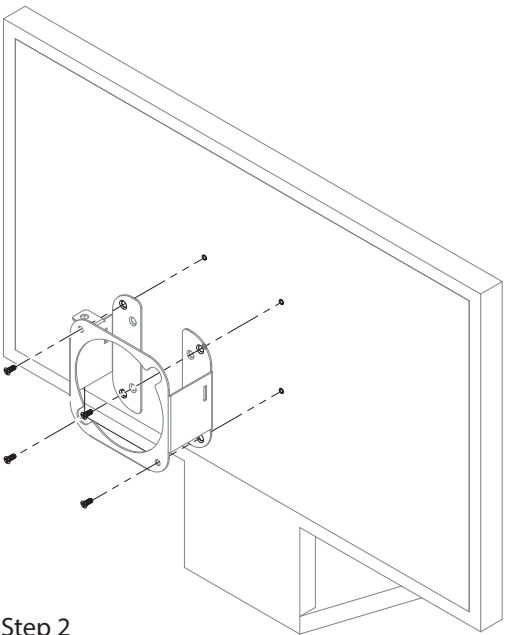
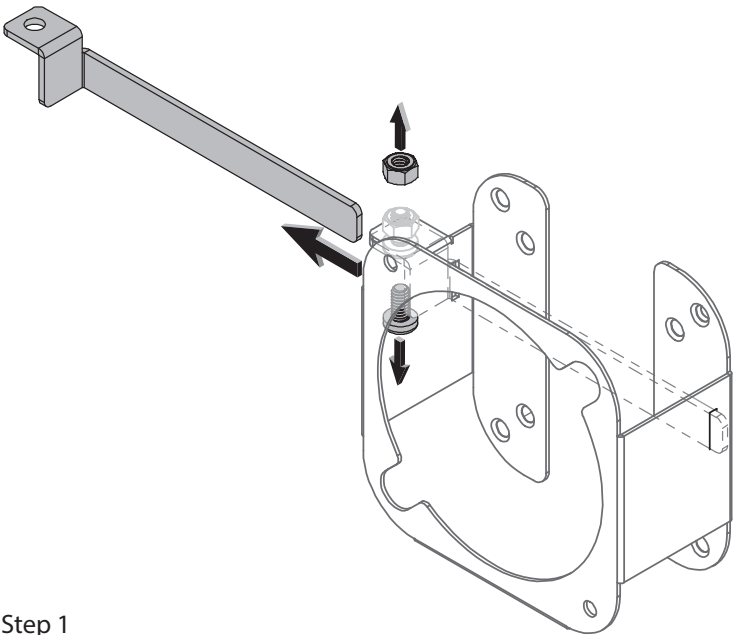
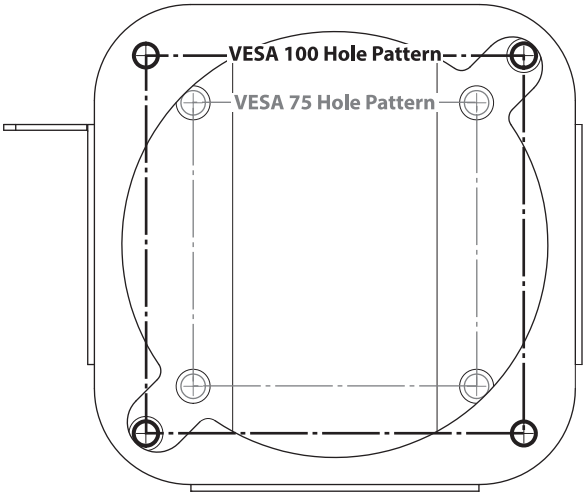
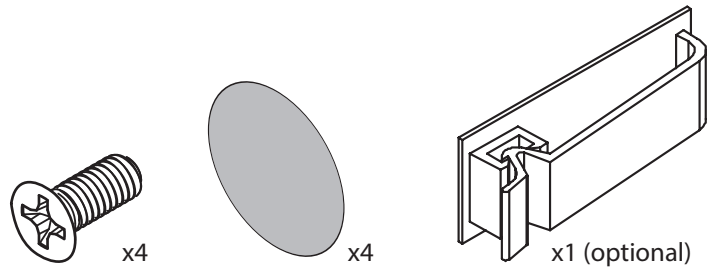

Monitor Mounting Instructions

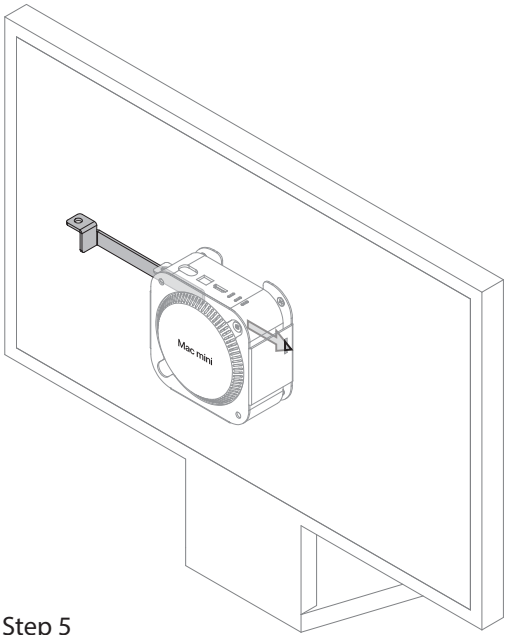

Step 5

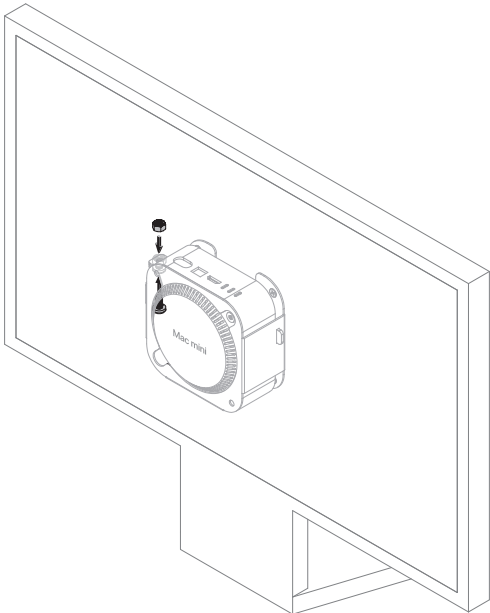
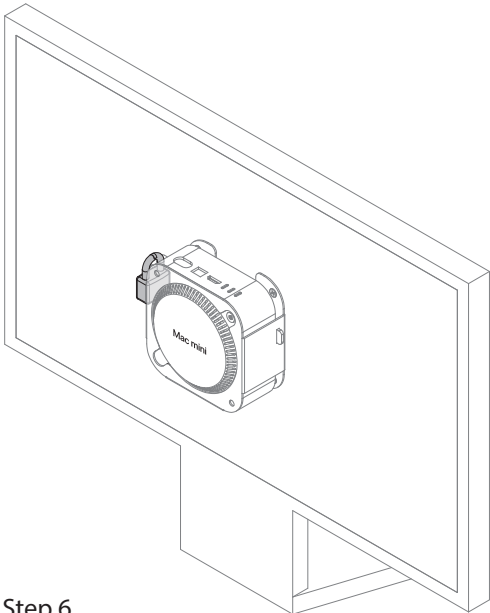

OR

Step 6

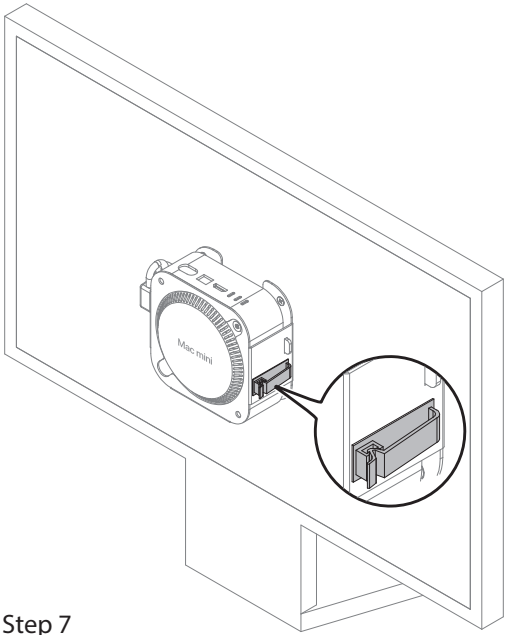

Step 7

Under Desk Mounting Instructions

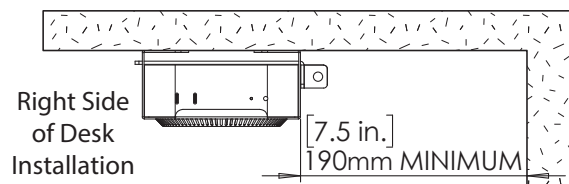
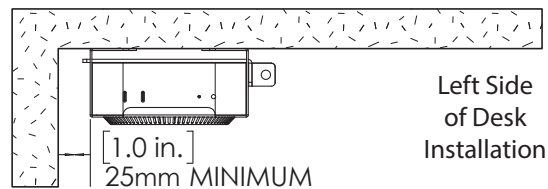
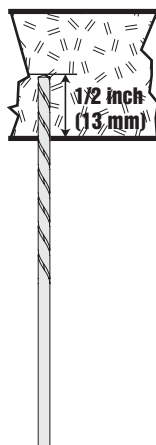
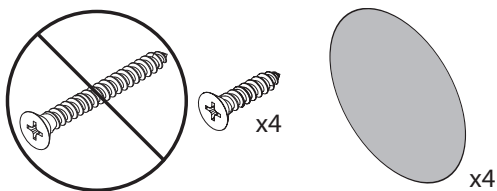

- Softwood 3/32-inch drill bit
- Hardwood 7/64-inch drill bit
- Metric 2.5mm drill bit

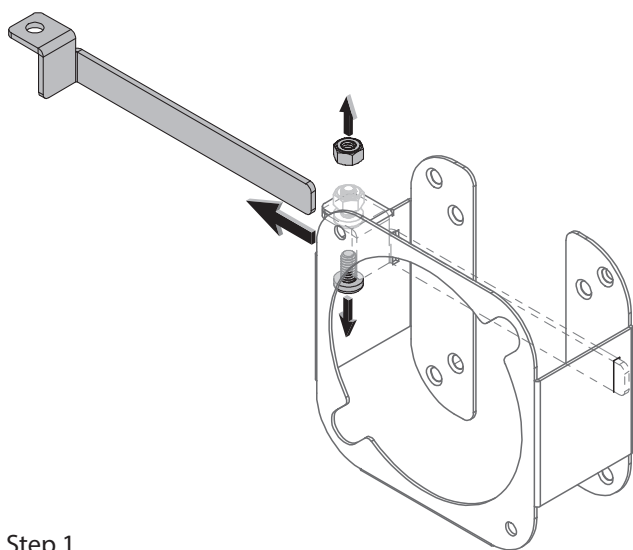

Step 1

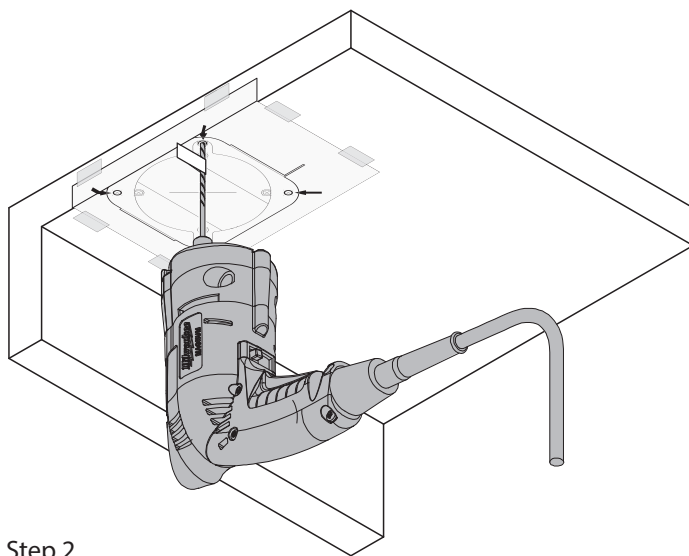

Step 2

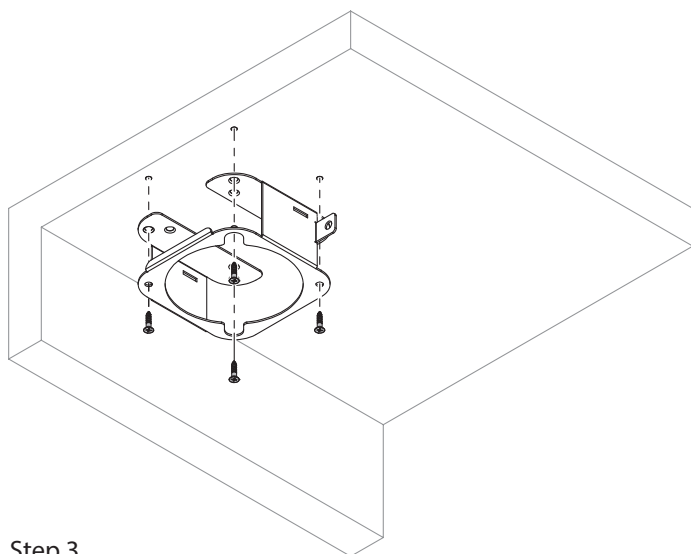

Step 3

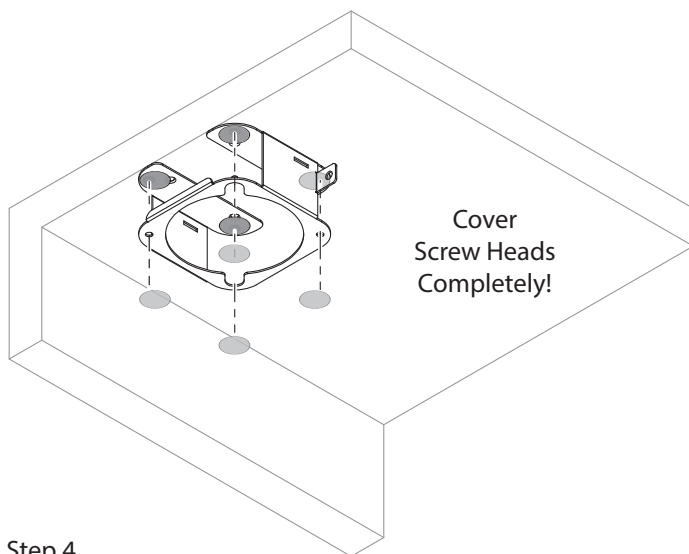

Step 4

Cover
Screw Heads
Completely!

Under Desk Mounting Instructions

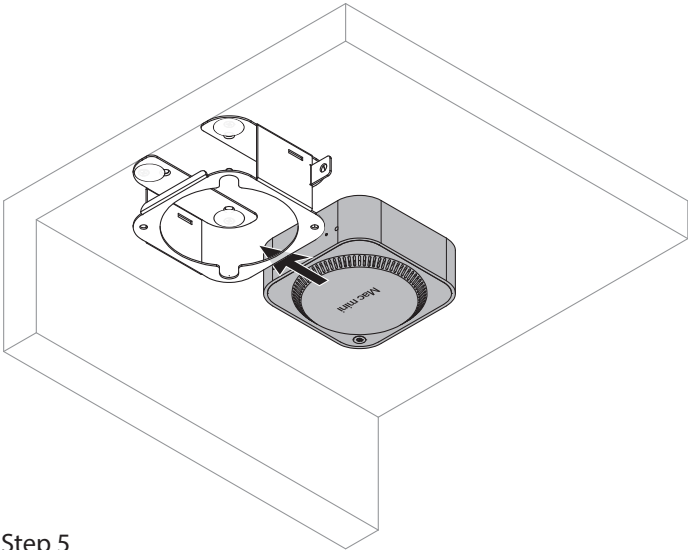

Step 5

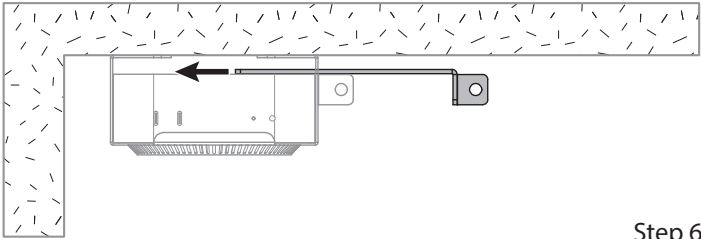

Step 6

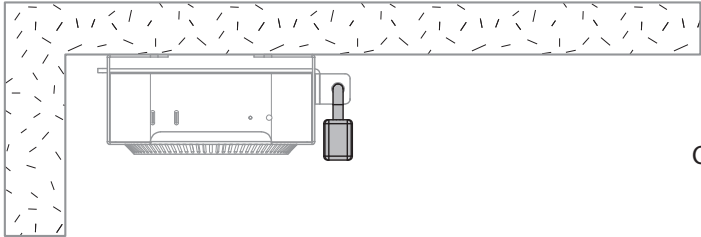

OR

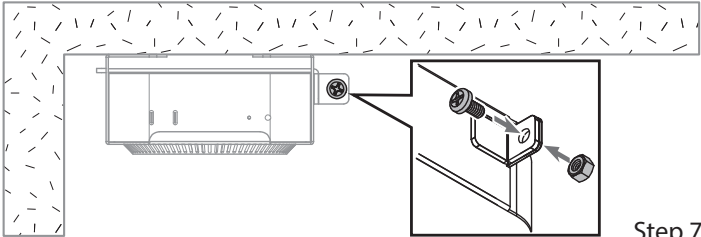

Step 7

Wall Mounting Instructions

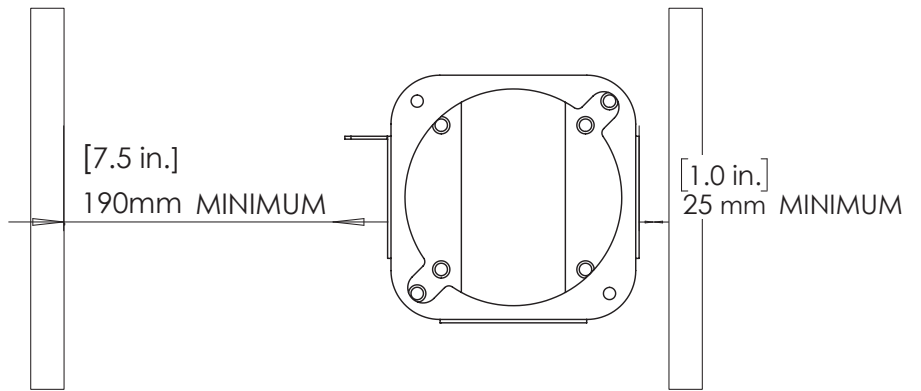
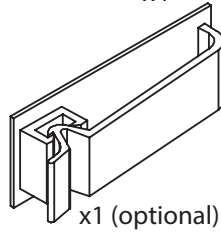
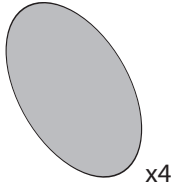
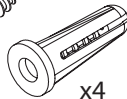
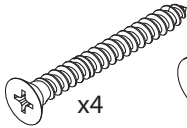

- 1/4-inch drill bit
- Metric 6mm drill bit

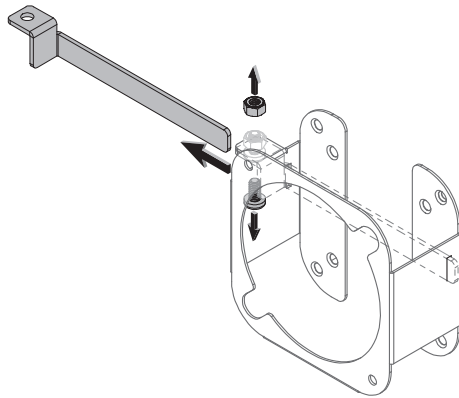

Step 1

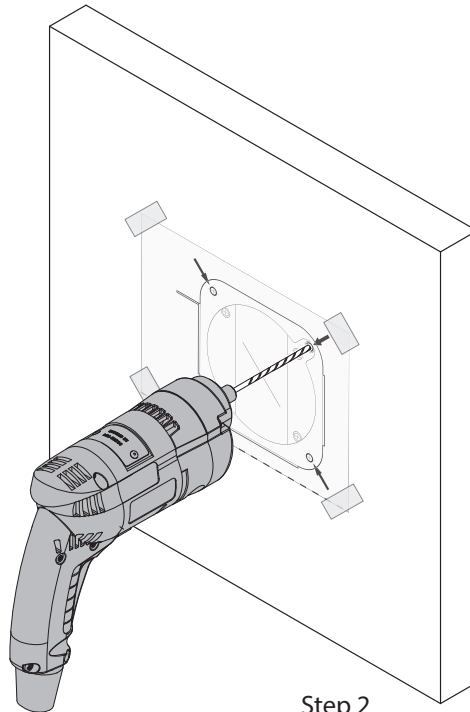

Step 2

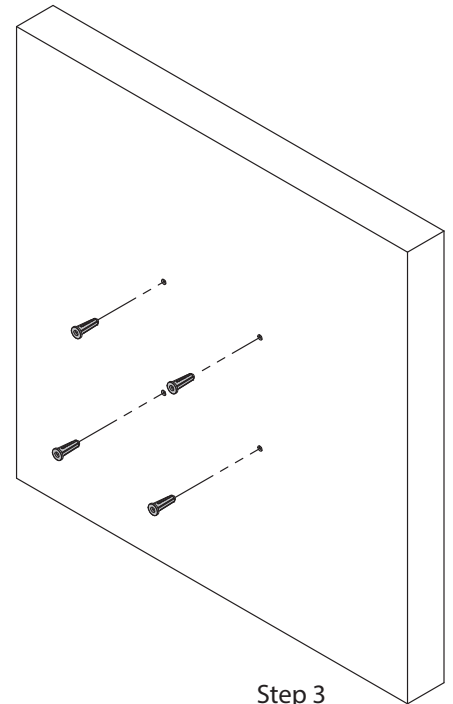

Step 3

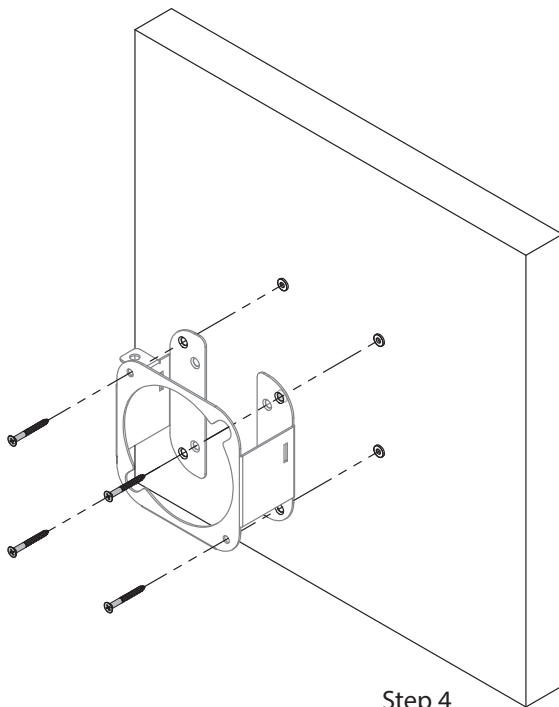

Step 4

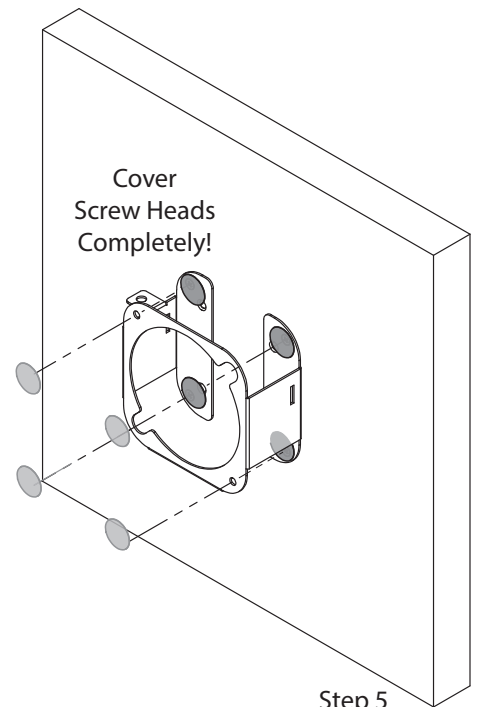

Step 5

Wall Mounting Instructions

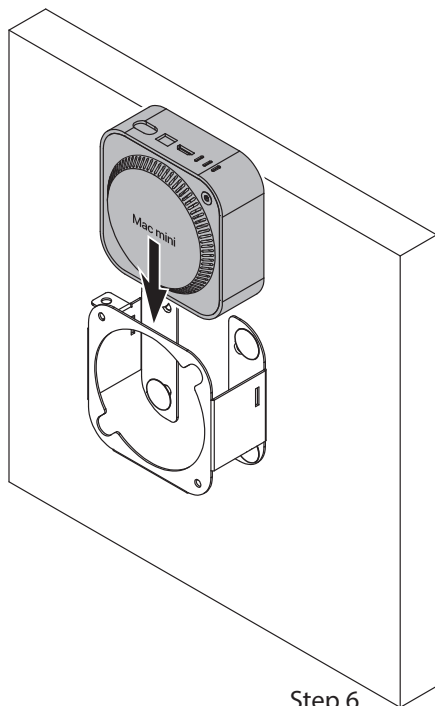

Step 6

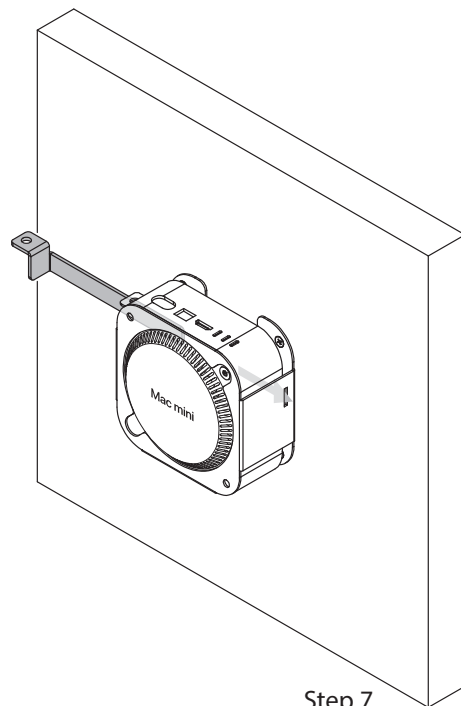

Step 7

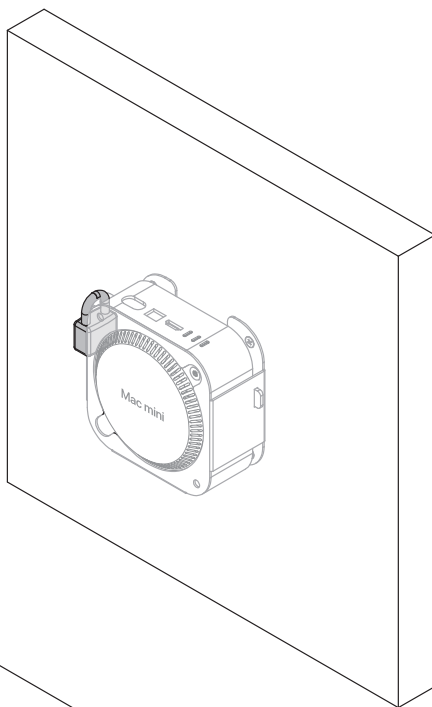

OR

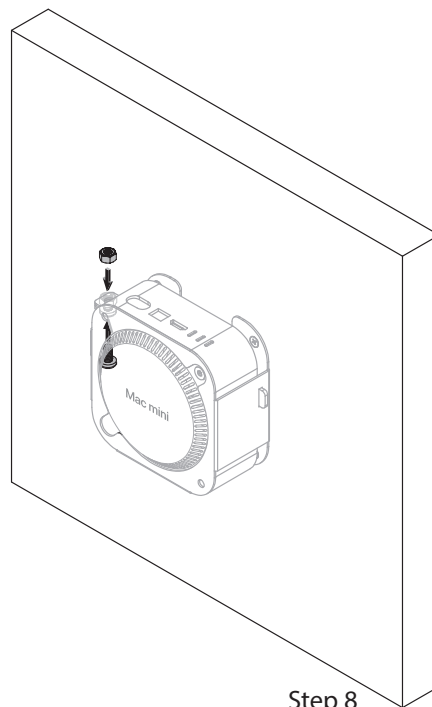

Step 8

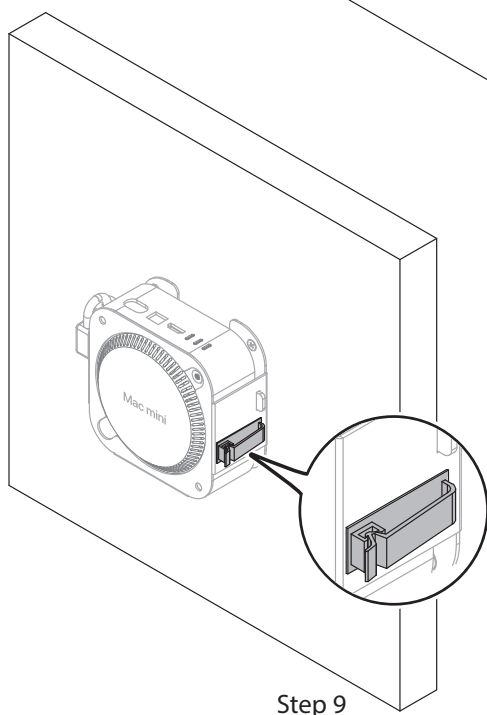

Step 9

